

CMS-ANT-KAB/20M

Antenna cable | SMA plug (male) / jack (female) | 2.5 m | 5 m | 10 m | 20 m



<b>Communication</b>	
Frequencies	0 ~ 6 Ghz
Antenna connector type	SMA male / female
Cable type / length	RG-58 / 2.5 m   5 m   10 m   20 m
Impedance	50 Ω
Max bending radius	25 mm

<b>Housing and environmental conditions</b>	
Storage temperature (no ice)	-20 ... 80 °C
Operation temperature	-20 ... 80 °C
Ingress Protection	IP 67 only when mated
Weight	630 g
Housing material	PE
Mounting	Panel mount option, see fig. 1
Dimensions	see fig. 2

<b>Product references</b>		
Description	Type	20
Antenna cable	CMS-ANT-KAB/...M	✓

“...” List cable length to complete product references.  
Other cable length on request. Please contact support@comatreleco.com.



fig. 1. Mounting

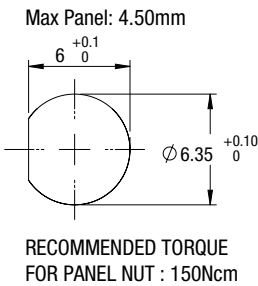
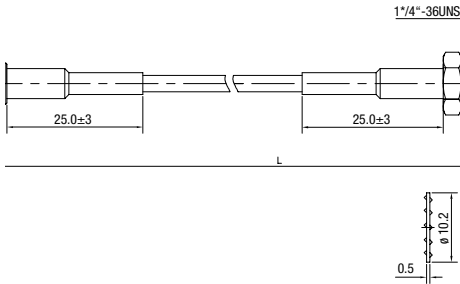

fig. 2. Dimensions (mm)



Technical approvals, conformities

Approvals **EAC**